

**19031 Mitchell Road**  
Pitt Meadows, V3Y 2C3

**RE/MAX**  
LIFESTYLES REALTY

Powered by [homes.mapleridgenews.com](https://homes.mapleridgenews.com)

**MLS# R3017139**

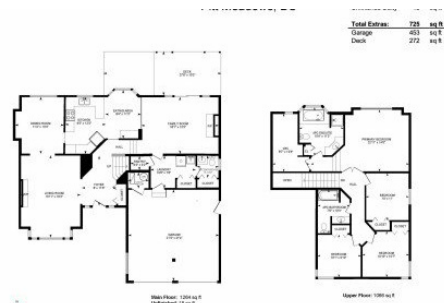

**\$1,630,000**

**4 Bedrooms | 3 Bathrooms | 2,330 Sqft**

FIRST TIME ON THE MARKET! Beautifully maintained 2348sq.ft, 2 storey home in a desirable neighbourhood with a fully landscaped & fenced 9191sq.ft lot. BONUS at back a DETACHED SINGLE GARAGE, easy access thru double gates & RV parking on side of home. Has 4 bedrooms up, primary bedroom with 10' ceiling, W/I closet & 4pce.ensuite, hardwood floors, big kitchen, S/S appliances, loads of cabinet space, 2 gas f/ps, large familyroom sliders to patio deck. Laundry on main floor. Large covered patio deck, hot tub & N/Gas BBQ outlet. Easy access to crawlspace for added storage. Furnace & Air conditioning 3 years, H.W tank 2 years. Property not in flood plain. Close to Mitchell Park, short walk to school, rec centre, bus stops, Westcoast Express, & easy access to Golden Ears Bridge.



**RE/MAX LifeStyles Maple Ridge**

Phone: (604) 466-2838

RE/MAX LifeStyles Realty

Office: (604) 466-2838

For full listing details, please scan:

